

## Pump system Aquapump Retrofit Duo, GTF 1400, Level sensor

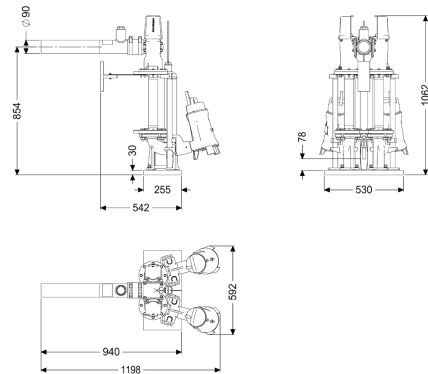

### Article information

Item no.: 8744020  
 GTIN: 4026092103517  
 Price group: 60

### Description

Twin pump system, for installation in an on-site chamber module. Required minimum diameter of the on-site chamber: 1000 mm

#### Variant

|                           |   |
|---------------------------|---|
| Type of system:           | duo pump  |
| Shut-off valve:           | yes   |
| Installation:             | Wet installation  |
| Pump control:             | Control unit  |
| Backflow preventer:       | integrated  |
| Pressure pipe connection: | vertical (special version, on request), horizontal (standard version) |

#### General characteristics

|                         |  |
|-------------------------|--|
| Standard:               | EN 12050-2 as well as EN 12050-1 (without ATEX requirements)                                 |
| Type of wastewater:     | for wastewater with or without sewage (in installation situations without ATEX requirements) |
| Installation situation: | installation in on-site collecting tank  |
| System type:            | Duo  |

#### Dimensions

|                      |          |
|----------------------|----------|
| Net weight:          | 103,6 kg |
| Gross weight:        | 103,6 kg |
| Packaging dimension: | length   |

|  |                                |
|--|--------------------------------|
| Packaging dimension:                               | width                          |
| Packaging dimension:                               | height                         |
| Tank/drain body                                    |                                |
| Pressure pipe connection (DN):                     | 80                             |
| Pressure pipe connection (OD):                     | 90 mm                          |
| Inlet nominal size (DN):                           | 150 mm                         |
| Pumping device                                     |                                |
| Pump:  | GTF 1400                       |
| Number of pumps:                                   | 2                              |
| Connection type:                                   | coded plug                     |
| Operating voltage:                                 | 230 V                          |
| Mains frequency:                                   | 50 Hz                          |
| Rated current:                                     | 6,5 A                          |
| Protection class:                                  | I                              |
| Protection class (pump):                           | IP 68 (3m)                     |
| Temperature monitoring:                            | integrated                     |
| Max. temperature (permanent) of conveyed material: | 40 °C                          |
| Max. pumping capacity:                             | 31 m <sup>3</sup> /h           |
| Max. pumping height:                               | 10,5 m                         |
| Speed:   | 2900 U/min                     |
| Power P1:  | 1,5 kW                         |
| Power P2:  | 1,1 kW                         |
| Operating mode:                                    | S1                             |
| Type of pump connection cable:                     | H07RN-F 3G 1.5 mm <sup>2</sup> |
| Impeller type:                                     | Multi-vane impeller            |
| Type of fuse required (electrical protection):     | C 16 A                         |
| Length of mains cable for pump:                    | 10 m                           |
| Control  |                                |
| Control unit:                                      | Comfort                        |
| Alarm sensor:                                      | Level sensor                   |
| Level measurement instrument:                      | Level sensor                   |
| Type of level measurement:                         | hydrostatic                    |
| Protection class control unit:                     | IP 54                          |
| Mains frequency:                                   | 50 Hz                          |
| Operating voltage:                                 | 230 V                          |
| Connection type:                                   | coded plug                     |
| Length of mains cable for control unit:            | 1,4 m                          |
| Potential-free contact:                            | optional                       |
| GSM interface:                                     | yes                            |
| USB interface:                                     | yes                            |
| Log book function:                                 | yes                            |
| Multi-line display:                                | yes                            |
| Battery buffering:                                 | yes                            |
| Self-diagnosis system (SDS):                       | yes                            |
| Type of fuse required (electrical protection):     | C 16 A                         |