

Hybrid lifting station Ecolift L Mono, FKA, SPF 1350-S3

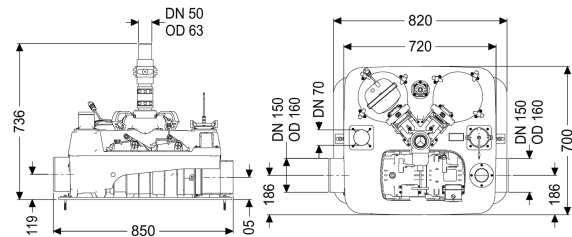

Article information

Item no.: 22002
 GTIN: 4026092105801
 Price group: 20

Advantages

- Hybrid function: uses the natural fall to the sewer - pump is only used in case of backwater
- Quiet and energy-saving
- Double safety due to backwater flap and pressure loop

Description

The alternative to a sewage lifting station. For faecal wastewater, bottom section made of PE-LD, for installation in an exposed drainage pipe, drainage via the gravity pipe to the sewer. Lifting function with one pump or two pumps, only in the event of backwater, the backwater flap can be closed by a motor, with an additional hinged flap. Drainage during the backwater phase takes place via an on-site pressure pipe that can be connected above the backwater level. Including a backflow preventer and shut-off valve for the pressure pipe. Including penetration seals DN 70 for the on-site ventilation pipe Polymer closure system for the drainage pipe for safe closure of the drainage pipe in the event of backwater. Consisting of a hinged flap including an emergency closure (for manual locking if required) and an electrically powered closure mechanism including a probe protected against wire breakage for the detection of backwater. Control unit with an integrated self-diagnosis system (SDS), display of the operating states and integrated battery back-up for alarm signals. User-friendly menu guidance in a multi-line display. With a self-diagnosis system (SDS) and reminder when maintenance is due. Display of the current measured values. Simple adjustment of the function-related parameters, including the operating hour counter and potential-free contact. Optional relaying of alarm and collective error messages via the GSM interface. Control unit with a full text display in six languages.

General characteristics

Colour:

black

Type of wastewater:

with sewage

Installation situation:	exposed drainage pipe
Approval:	Z-53.2-493
Type de protection moteur:	IP 68
ATEX:	no

Dimensions

Net weight:	39,53 kg
Gross weight:	65,25 kg
Length:	700 mm
Width:	850 mm
Height:	736 mm
Packaging dimension:	length
Packaging dimension:	width
Packaging dimension:	height

Tank/drain body

Pressure pipe connection (DN):	50
Pressure pipe connection (OD):	63 mm
Outlet nominal size (DN):	150 mm
Pumping volume:	20 l

Wastewater contents

Total volume:	66 l
---------------	------

Pumping device

Pump:	SPF 1350
Number of pumps:	1
Rated current:	6 A
Protection class (pump):	IP 68 (3m/48h)
Max. pumping capacity:	26 m ³ /h
Max. pumping height:	10 m
Power P1:	1,35 kW
Power P2:	0,86 kW
Operating mode:	S3 - 50 %
Type of fuse required (electrical protection):	C 16 A
Impeller type:	Multi-vane impeller
Free passage:	40 mm
Length of mains cable for pump:	5 m
Length of mains cable for flap motor:	5 m

Control

Control unit:	Comfort
Level measurement instrument:	Immersion pipe
Type of level measurement:	pneumatic
Mains frequency:	50 Hz
Operating voltage:	230 V
Length of mains cable for control unit:	1 m
Rated current:	6 A
Type of fuse required (electrical protection):	C 16 A